



LOA	15.40 m 50'6"
Hull length	14.85 m 48'9"
LWL	13.54 m 44'5"
Beam	4.751 m 15'7"
Draft	2.38 m 6'9" (standard) 1.98 m 6'6" (option)
Displacement	approx. 14 t approx. 30.900 lb
Ballast	approx. 4.000 kg approx. 8.8300 lb (standard) approx. 4.450 kg approx. 9.820 lb (option)
Engine	53 kW / 72 HP
Fresh water	approx. 650 l
Fuel tank	approx. 300 l
CE Certificate	A (ocean)
Mast length above WL	approx. 22.10 m approx. 66'7"
Total sail area	approx. 129.00 m ² approx. 1.390 sq ft
Main sail	approx. 67.50 m ² approx. 727 sq ft
Self-tacking jib	approx. 51.50 m ² approx. 554 sq ft
Rig	I 19.55 m 64'2" J 5.85 m 19'2" P 18.35 m 60'3" E 6.15 m 20'2"
Design	judel / vrolijk & co
Interior	Watervision & Schnasse Interior Design

Modellyear 2010/2011 – valid from November 26, 2010

STANDARD

OPTIONS

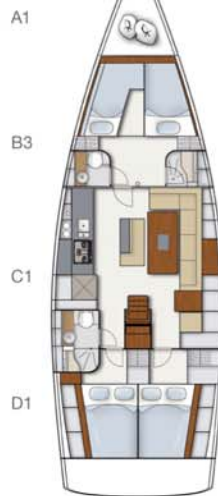
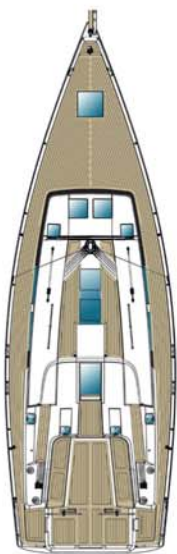

Hull

- White hull
- Dark grey double waterlines
- Options for different hull colours according to Hanse colour selection
- Isophthalic gelcoat
- Vinyloester for all outer laminates
- Balsa sandwich above waterline
- Polyester inner laminate (orthophthalic or DCPD)
- Main bulkhead laminated to hull and deck
- GRP strongbacks
- Hull windows

Deck

- White deck with non slip surface
- Isophthalic gelcoat
- Vinyloester 1st layer
- Bulk laminate polyester (orthophthalic or DCPD)
- Balsa sandwich

Steering System

- Twin wheel steering system
- 2 leather covered steering wheels
- Semi-balanced, profiled rudder with alloy shaft and self-aligning needle bearings
- Emergency tiller

Keel

- Standard: T shape keel draft: 2,38 m
- Option: L shape shallow cast iron keel draft: 1,98 m
- Stainless steel keel bolts

Deck Equipment

- Teak on cockpit seats
- Partial moulded non-skid surface on the coach roof and side decks
- Engine control at helm station stb
- 6 retractable mooring cleats
- Self-draining chain locker with electrical windlass
- Fixed anchor arm with anchor roller and teak foot step with integrated pad eye
- Stainless steel cockpit table in teak with S/S chart plotter bracket
- Foredeck sail storage with ladder and big hatch and watertight access hatch to chain locker
- Hot & cold shower on aft deck
- Self-draining cockpit
- Halyard storage bags in the cockpit
- Storage for gas bottle, self draining
- Stainless steel swimming ladder
- Dedicated space for life raft
- Hinged swimming platform with integrated helmsman seats
- Self tacking jib track, fully integrated in the foredeck
- Mid boom sheeting with 2 stand-up blocks
- 2 x 5 sheave deck organizers
- 10 deck jammers
- 2 x Pad eyes for Jib
- 7 Flush hatches
- 4 hatches
- 4 opening side windows on coach roof
- 2 large opening portlights in cockpit
- Stainless steel pushpit with ensign flag socket
- LED navigation light on transom
- Stainless steel split pulpit with LED navigation lights
- Stainless steel stanchions tapered
- Rail gates on both sides
- 4 winches in cockpit:
- 2 primary winches 54 AST
- 2 secondary winches 54 AST

Technical System**Plumbing System / Fresh Water**

- Tank**
- 2 x fresh water tanks, total capacity approx. 650 l (2 tanks)
- Water infill on deck
- Hot water**
- 20 l water heater, running from engine and immersion heater 230 V

Draining Pumps**Bilge pumps**

- 1 manual bilge pump
- Connection in bilge
- 1 electric bilge pump with automatic switch

Toilet / Head

- 2 x manual marine toilets
- 2 x holding tank (2 x 35 l) with sea and deck discharge

Engine

- Volvo D2-75 (53 kW/72 HP), diesel engine
- Sail drive
- 3 bladed fixed propeller
- 2 x fuel tanks, total capacity approx. 280 l
- Fuel infill on deck
- Fuel filter / Water separator
- Engine room sound insulated and illuminated with room for generator above engine

Electrics

- 12V and 110V/230 V

Batteries

- Main battery switches
- Engine battery: 12V/80Ah AGM
- Service battery bank: 12V/2x150Ah AGM

Battery charger/Shore power

- Charger LG 12V/50A
- Isolator switch
- 230 V shore supply protected with differential breaker and distribution system

Electric control panel 110V/230V

- Differential breakers
- Control gauges
- Voltmeter

Electric control panel 12V

- Switches for all onboard electrics (upgraded instrument panel)
- Voltmeter and battery control (digital)
- Water / Fuel gauges

12V electric equipment

- Electrical anchor windlass
- Pumps
- Navigation lights LED
- Interior lights
- Refrigerator

Outlets 230V

- at chart table single outlet
- in fwd. cabin one each
- in aft. cabin one each
- in galley twin outlet
- in saloon twin outlet
- in heads one each

Outlets 12V

- at chart table
- at helm station

Interior lighting

- Overhead lighting in cabins, saloon, galley and heads
- Lighting in engine compartment
- Reading lights in saloon and cabins
- Night light on companion way

Navigation lights

- Navigation lights LED on pulpit and pushpit
- Steaming light
- Anchor light

Navigation instruments

- Compass illuminated
- Speedometer and depth sounder

Galley

- Solid CorianTM surface, black quartz with integrated double sink
- 2-burner LPG stove with oven, gimble
- LPG gas system and self draining LPG bottle storage in cockpit
- 2 x large drawer S/S fridge of approx. 140 l,
- Lockers and drawers
- Waste bin
- Option for microwave
- Option for fridge or freezer
- Option for coffeemaker
- Option for dishwasher
- Option for wine cooler
- Option for washing machine
- Option for steam cooker

Interior Accommodation

- High quality marine plywood, light mahogany veneer, satin varnish
- Maple style floorboards
- Option: beech satin varnish
- Option: cherry style floorboards
- Option: high gloss varnish
- White bulkheads
- Wooden door frames
- Wood / Sandwich doors

Upholstery

- According to Hanse colour selection

A1 – storage room

- Access watertight hatch to chain locker
- Ladder

A2 – crew cabin

- Single berth
- 1 reading lights
- Sink with mixing tab
- Marine toilet
- Storage space

B1 – owner's fwd cabin

- "island" double berth
- 2 reading lights
- 1 large hanging locker with shelves
- 1 smaller hanging locker with shelves
- 2 shelves along the hull
- 2 hull port lights
- 2 large hatches
- Entrance door
- Cosmetic table
- Separate head with lockers and mirror
- Separate shower compartment
- 2 small opening flush hatches for head and shower

B2 – 2 fwd cabins

- Double berth in each cabin

- 2 reading lights for each cabin
- Shelves along the hull with fiddles,
- 1 large hanging locker with shelves in each cabin
- 1 hull port light in each cabin
- 1 large flush hatch in each cabin
- Entrance door for each cabin
- Separate head with lockers and mirror
- Separate shower compartment
- 2 small opening flush hatches for head and shower
- B3 – 2 split berths**
- 2 single berths port and stb
- 2 reading lights
- 1 large hanging locker with shelves
- 1 smaller hanging locker with shelves
- 1 shoe locker between berths fwd
- 2 shelves along the hull
- 2 hull port lights
- 2 large hatches
- Entrance door
- Cosmetic table
- Separate head with lockers and mirror
- Separate shower compartment
- 2 small opening flush hatches for head and shower
- C1 – saloon**
- L settee on stb side with fixed table with bottle storage
- Center piece with bench and dedicated space for TV lifter
- 2 reading lights on the fwd bulkhead
- Shelves and lockers along the hull with fiddles,
- 2 hull large port lights
- Fwd looking navigation table on stb. with lockers drawers and shelves
- Galley along the hull with drawers and storage space
- Freezer optional
- 2 burner stove with oven
- 2 x S/S sinks with mixing tab
- Day head with separate shower stall divided by plexy glass
- Hangers for wet cloths in the shower stall
- 2 hatches
- 4 opening side coachroof portlights
- 2 overhead handrail integrated
- dedicated space under floorboards
- D1 – 2 aft cabins**
- Double berth
- Hanging locker with shelves
- 2 reading lights
- Lockers along the hull
- 1 hull portlight
- 1 opening overhead portlight in port cabin
- 2 opening overhead portlights in stb cabin
- 1 large opening cockpit portlight
- D2 – owner's aft cabin**
- Double berth
- Hanging lockers with shelves
- 2 reading lights
- Shelves along the hull
- 2 hull portlights
- 2 opening overhead portlights
- 2 large opening cockpit portlight
- Entrance door to head on port
- Entrance door to saloon on stb
- Bench on port side
- Storage space underneath the double berth

Rigg and Sails

- 2 spreader silver deck stepped anodised mast, tapered
- North Sails cruising set of sails
- Boom with 2 reefing lines
- Furling system for jib under Deck
- Main halyard
- Jib halyard
- Mid boom sheeting with 2 stand-up blocks
- Jib sheet
- Rod kicker
- Backstay adjuster
- "German" mainsheet system